

STEPPED STREET LIGHTING POLES WITH LONG ARM BRACKET

Illustration of some standard stepped poles with long arm bracket for Street Lighting applications, complying with SASO specifications. However, specifications can be catered as per the requirements of clients.

I. Pole Size (mm)									II. Arm Size (mm)			
"H"	"h1"	"ØD1xt"	"h2"	"ØD2xt"	"h3"	ØD3xt	"h4"	ØD4xt	"h"	"L"	"R"	"ØD x t"
6,000	3,000	141.3x4.0	1800	88.9x3.25	--	--	--	--	1,200	1,000	700	60.3 x 2.90
7,000	3,000	141.3x4.0	1,800	114.3x4.0	1,000	76.1x3.25	--	--	1,200	1,000	700	60.3 x 2.90
8,000	3,000	168.3x4.0	1,800	114.3x4.00	2,000	76.1x3.25	--	--	1,200	1,500	700	60.3 x 2.90
9,000	3,000	168.3x4.0	2,800	114.3x4.0	2,000	76.1x3.25	--	--	1,200	1,500	700	60.3 x 2.90
10,000	4,000	168.3x4.0	2,800	114.3x4.0	2,000	76.1x3.25	--	--	1,200	1,500	700	60.3 x 2.90
12,000	4,000	193.7x4.0	3,800	114.3x4.0	2,200	76.1x3.25	--	--	2,000	2,000	1,000	60.3 x 3.65
14,000	4,000	219.1x5.6	3,750	141.3x4.0	2,800	114.3x4.00	1,450	88.9x3.6	2,000	2,500	1,500	60.3 x 3.65
15,000	4,000	219.1x5.6	3,750	193.7x4.0	3,800	168.3x4.00	1,450	114.3x4.0	2,000	2,500	1,500	60.3 x 3.65

Pole + Bracket Details

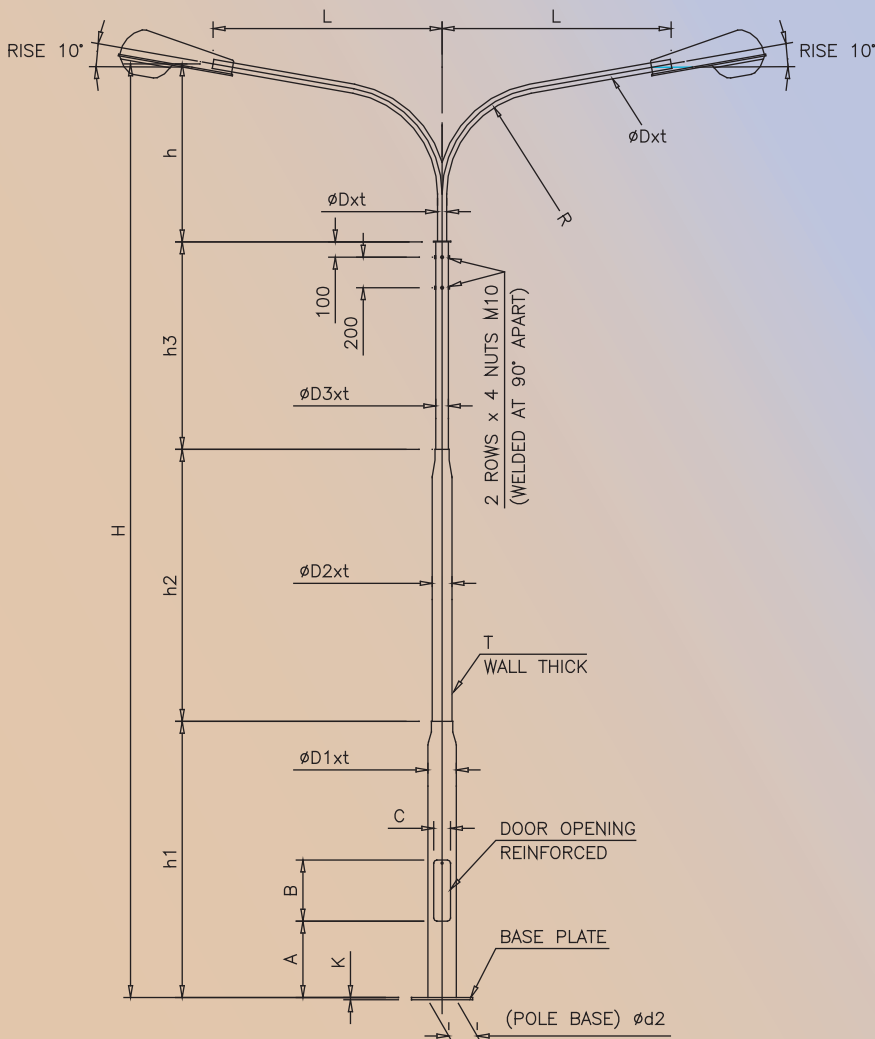

Door Opening Details

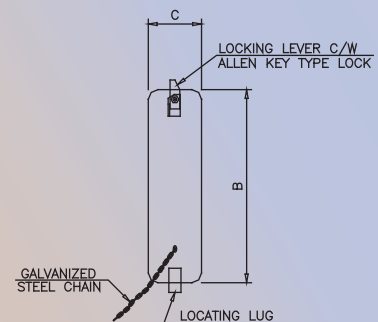
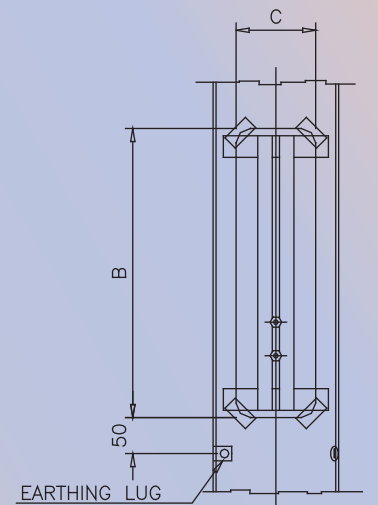

STEPPED STREET LIGHTING POLES

III. Door Opening	IV. Flange Plate Size	V. Anchor Bolts Size	Abbreviations/Notes
-------------------	-----------------------	----------------------	---------------------

"A"	"B"	"C"	"D"	"E"	"F"	"G"	"K"	"ØPxQ"	"R"	"M"	"Qty"
600	300	70	300	200	22	35	10	18x400	50	100	4 Nos
600	400	90	400	300	28	45	10	24x500	50	100	4 Nos
600	400	90	400	300	28	45	10	24x500	50	100	4 Nos
600	400	110	400	300	28	45	15	24x500	50	100	4 Nos
600	400	110	400	300	28	50	15	27x500	50	100	4 Nos
600	400	110	400	350	32	50	20	27x700	75	120	4 Nos
600	500	120	400	300	32	45	25	27x700	75	120	4 Nos
800	600	130	450	350	35	50	25	30x1000	75	150	4 Nos

Abbreviations :

(I) Pole Size :
 H = Overall height
 h1 = Height of bottom shaft
 h2 = Height of middle shaft
 h3 = Height of top shaft
 t = Shaft Wall Thickness

(II) Arm Size :
 h = Bracket height,
 L = Outreach
 R = Radius
 Dxt = Diameter x thickness.

(III) Door Opening :
 A = Door opening ht above ground
 B = Door size
 C = Door width.

(IV) Flange/Base Plate :
 D = Dimension
 E = Dist. between holes
 F = Hole width
 G = Hole length
 K = Plate Thickness.

(V) Anchor Bolts :
 P = Bolt dia
 Q = Bolt height
 R = Radius
 N = Bending height
 Q = No. of bolts required/Pole.

Flange Plate Details

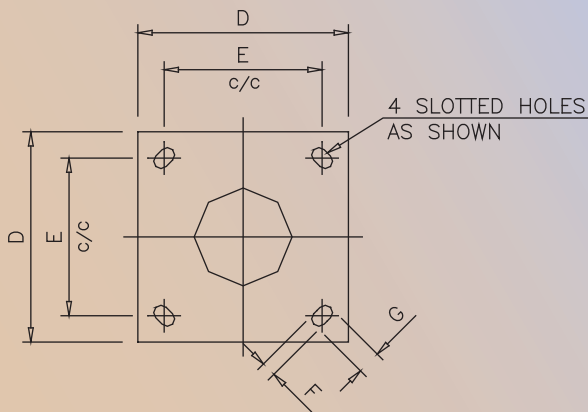

Anchor Bolt Details

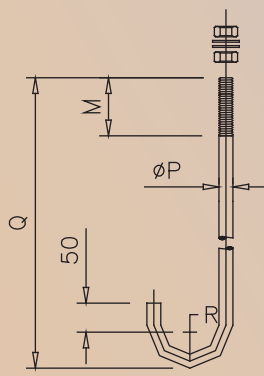

- Notes :**
1. All dimensions are in mm
 2. Design compliance with BS EN 40:2000 Loads BS CP3, Chapter 5, Part-2
 3. Maximum wind speed 160 Km/Hr.
 4. Finish : Hot dip galvanized to BS ISO 1461 (or as specified).
 5. Accessories are made of Mild Steel Grade.
 6. Shaft made of Steel Grade FE 430C (According to EN 10025).